



FITZJOHN
SALES & LETTINGS

76 Central Avenue,
Dogsthorpe, Peterborough,
PE1 4LH

Tel 01733 921700
info@fitzjohnstateagents.com
www.fitzjohnstateagents.com



35 Brookfield Home Park Dukesmead Peterborough PE4 6FB

Asking price £119,995



NO FORWARD CHAIN with this detached park home, for over 50's only, located North of Peterborough within easy access to road links, local shops and amenities. Accommodation comprises entrance hall, two bedrooms, en suite to master, two reception rooms, two conservatories, bathroom, kitchen, low maintenance garden to rear with artificial lawn area, paved patio seating area and two sheds. Two driveways provide ample off road parking.



*** FOR OVER 50'S ONLY ***

Entrance Hall Door to:

Bedroom 2 3.51m (11'6") x 2.95m (9'8") Window to front, built-in triple wardrobe(s), built-in double wardrobe(s), drawers, radiator, fitted carpet, coving to textured ceiling.

Bathroom Fitted with three piece suite comprising panelled bath, vanity wash hand basin and low-level WC, tiled surround, window to front, radiator, tiled flooring, coving to textured ceiling.

Bedroom 1 3.15m (10'4") x 3.00m (9'10") Window to rear, radiator, fitted carpet, coving to textured ceiling, door to:

En-suite 3.00m (9'10") x 1.56m (5'1") Fitted with three piece suite comprising vanity wash hand basin, double shower cubicle and low-level WC, tiled surround, heated towel rail, window to side, tiled flooring, coving to textured ceiling.

Kitchen 4.74m (15'6") x 3.00m (9'10") Fitted with a matching range of base and eye level units with worktop space over, 1+1/2 bowl sink unit with single drainer and mixer tap, built-in automatic washing machine, space for fridge/freezer, built-in fan assisted oven, built-in four ring electric hob with extractor hood over, window to rear, radiator, tiled flooring, coving to textured ceiling, door to Storage cupboard, airing cupboard housing, hot water tank.

Conservatory 3.73m (12'3") x 2.03m (6'8") UPVC double glazed construction with polycarbonate roof and power and lights connected, vinyl flooring, double door to rear.

Dining Room 2.54m (8'4") x 2.44m (8') Bay window to side, radiator, wooden laminate flooring, dado rail, wall light(s), coving to textured ceiling, open plan.

Living Room 4.93m (16'2") x 3.98m (13'1") Window to front, wall mounted gas fireplace, radiator, wooden laminate flooring, TV point, dado rail, wall light(s), coving to textured ceiling, double door through to :

Conservatory 3.30m (10'10") x 2.39m (7'10") UPVC double glazed construction with polycarbonate roof, fitted carpet, sliding patio door opens onto raised composite decking.

Outside
Enclosed by brick wall, paved sun patio seating area, decking and area, mainly laid to artificial lawn. Two garden sheds and two separate driveways for parking.

Area Map



Floor Plans

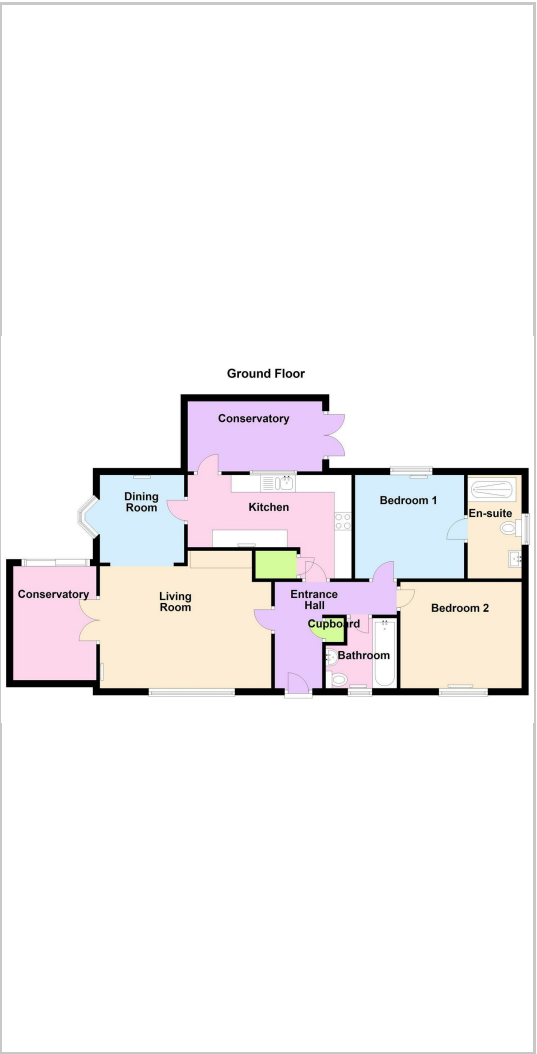

Energy Efficiency Graph

